



SAFIT Srl

Via Casonetto,17
36050 Friola (VI)
-- ITALY --
Tel.0444 668335

**Technical Data Sheet
Steel toe cap**

Tabella Dimensionale

Puntali Acciaio

Type

Modello

107MR

MADE IN ITALY

Written by: Nikola Kostic

Date: 07/01/2023

Rev.02

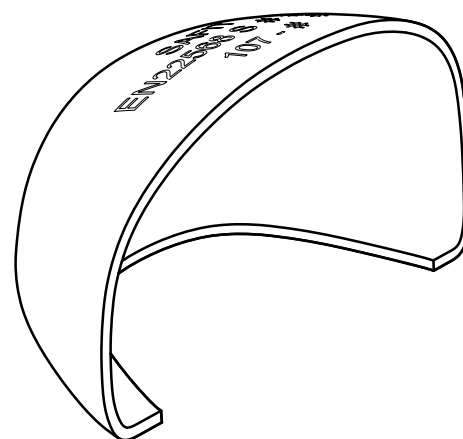
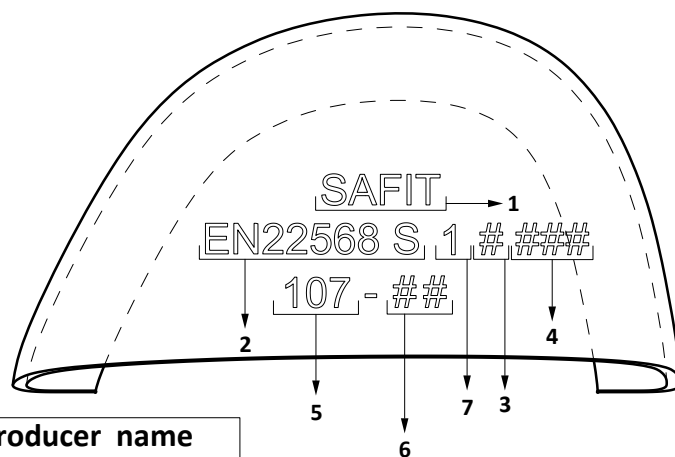
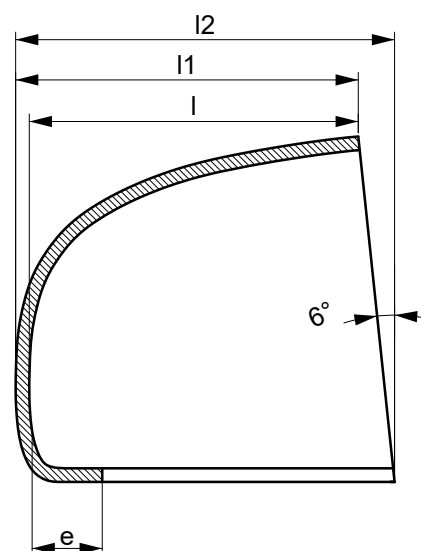
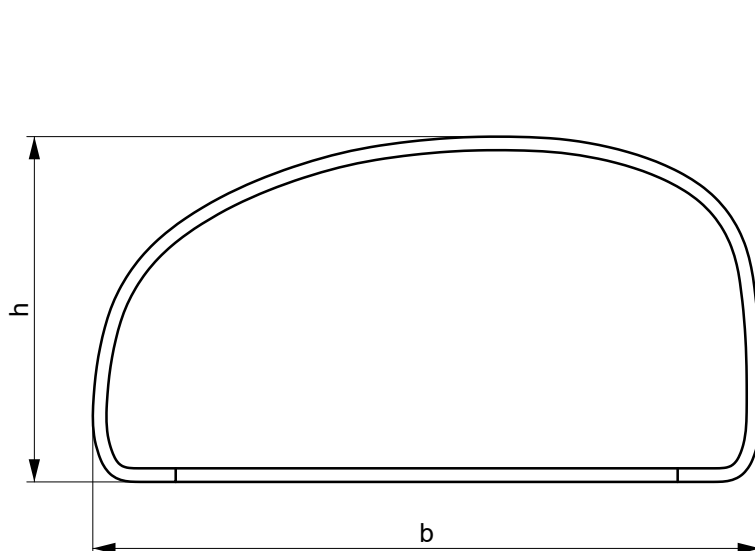

1	producer name
2	normative ref.
3	type A or B
4	batch number
5	model
6	size/R or L
7	metallic toe caps ref.

average hardness of steel releaved
on the top of the toe in the center position :HRc = 48 ± 2

dimension unit:		millimeter											KG
Tolerance:		±0,05	±0,7	±0,5	±1	±1	±1	-2/+2	Minimal requirement of		Average performance		± 0,010
Size #	strip length code ref.:	raw material thickness	b	h	l1	l2	l	e	ISO EN 22568:1 A	ISO EN 22568:1 B	200J	15KN	Weight (1 pairs)
4													
5													
6	GAA-3	1,8	80,2	39,0	41,5	46,1	39,7	8,0	20,0	24,0	24,0	32,0	0,181
7	GAA-4	1,8	84,9	42,2	44,5	49,6	42,7	8,0	20,5	24,5	24,5	33,5	0,200
8	GAA-5	1,8	88,2	43,7	48,5	49,7	41,7	8,0	21,0	26,0	27,0	36,1	0,203
9	GAA-5	1,8	88,9	46,2	50,0	51,4	43,0	8,0	21,5	26,0	29,0	36,0	0,220
10	GAA-6	1,8	91,0	47,8	51,0	52,5	44,8	8,0	22,0	26,0	29,5	36,0	0,229
11	GAA-7	1,8	93,6	49,5	51,9	53,5	46,7	8,0	22,0	26,0	30,0	37,5	0,251
12													

Conformity to the norm Conforme alle norme	<input checked="" type="checkbox"/> ISO EN 22568:1 A	<input checked="" type="checkbox"/> ISO EN 22568:1 B	<input checked="" type="checkbox"/> ANSI/ASTM	<input checked="" type="checkbox"/> CSA
---	--	--	---	---