



**SAFIT Srl**

Via Casonetto,17  
36050 Friola (VI)  
-- ITALY --  
Tel.0444 668335

**Technical Data Sheet  
Steel toe cap**

**Tabella Dimensionale**

**Puntali Acciaio**

**Type**

**Modello**

**130RR**

MADE IN ITALY

Written by: Nikola Kostic

Date: 07/01/2023

Rev.02

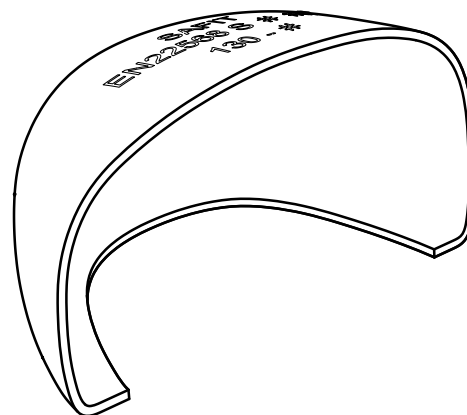
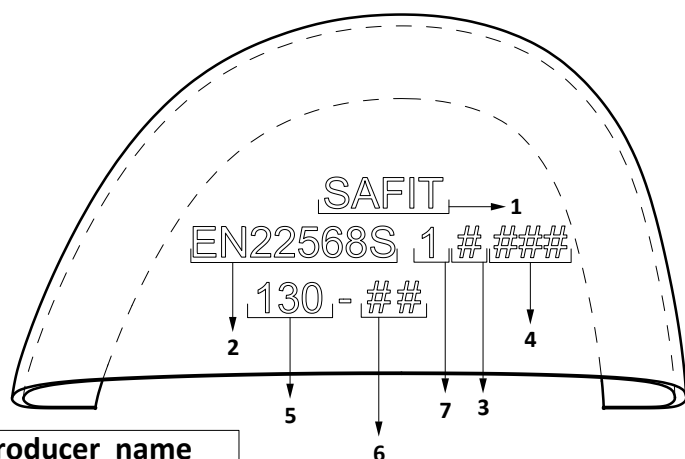
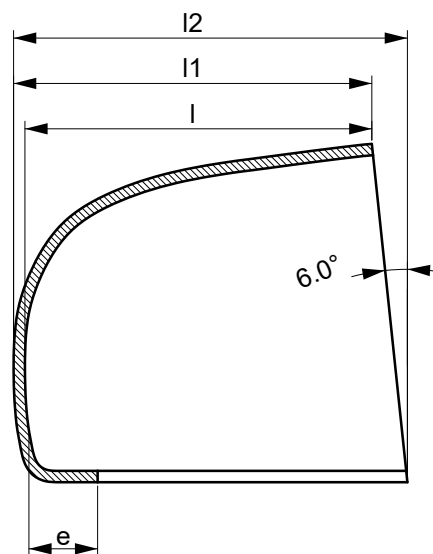
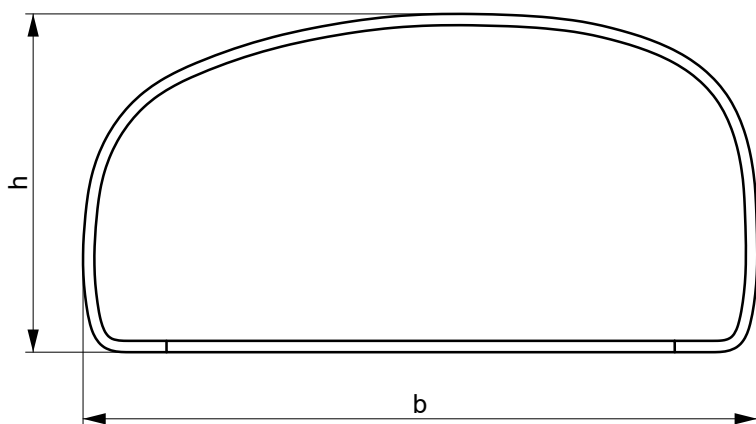

1	producer name
2	normative ref.
3	type A or B
4	batch number
5	model
6	size/R or L
7	metallic toe caps ref.

average hardness of steel releaved  
on the top of the toe in the center position : HRc = 48 ± 2

dimension unit:		millimeter										KG	
Tolerance:		±0,05	±0,7	±0,5	±1	±1	±1	-2/+2	Minimal requirement of		Average performance		± 0,010
Size #	strip lenght code ref.:	raw material thickness	b	h	l1	l2	l	e	ISO EN 22568:1 A	ISO EN 22568:1 B	200J	15KN	Weight (1 pairs)
4													
5													
6	GAA-4	2,0	82,3	42,5	43,0	47,3	40,5	7,5	20,0	24,0	29,0	35	0,201
7	GAA-5	2,0	84,9	44,7	45,5	50,3	42,7	7,5	20,5	24,5	31,0	37	0,224
8	GAA-5	2,0	88,0	45,5	46,2	51,4	43,5	6,5	21,0	25,0	32,0	37	0,241
9	GAA-6	2,0	90,1	46,8	47,5	52,7	44,8	7,5	21,5	25,5	32,5	38	0,259
10	GAA-6	2,0	91,3	47,2	52,5	53,7	45,2	9,5	22,0	26,0	32,0	39	0,262
11	GAA-7	2,0	94,8	50,5	51,7	53,0	48,5	8,0	22,0	26,0	34,0	40,5	0,274
12	GAA-7	2,0	96,5	51,0	49,2	54,8	49,0	6,5	22,0	26,0	34,0	40,5	0,263
13	GAA-7	2,0	98,2	51,9	50,3	56,2	49,9	6,5	22,0	26,0	35,5	41	0,284

Conformity to the norm Conforme alle norme	<input checked="" type="checkbox"/> ISO EN 22568:1 A	<input checked="" type="checkbox"/> ISO EN 22568:1 B	<input checked="" type="checkbox"/> ANSI/ASTM	<input checked="" type="checkbox"/> CSA
---	--	--	---	---