



SAFIT Srl

Via Casonetto,17
36050 Friola (VI)
-- ITALY --
Tel.0444 668335

**Technical Data Sheet
Steel toe cap**

Tabella Dimensionale

Puntali Acciaio

Type

Modello

131

MADE IN ITALY

Written by: Nikola Kostic

Date: 07/01/2023

Rev.02

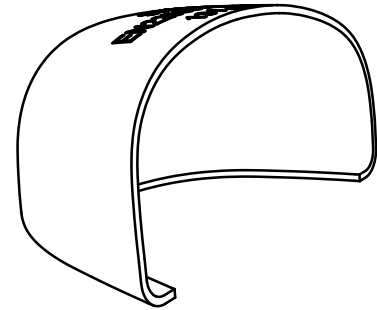
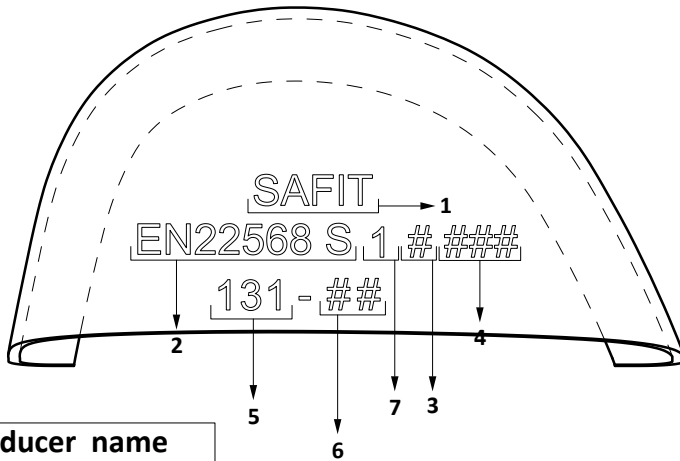
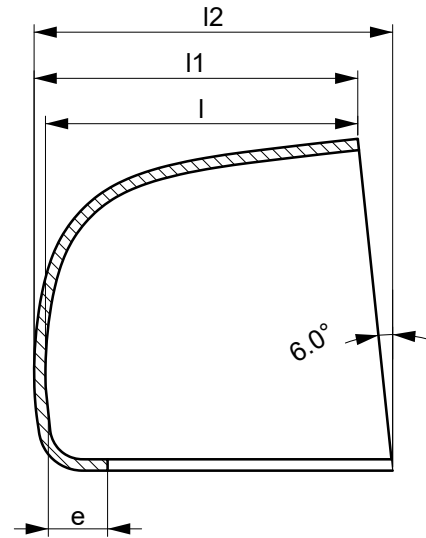
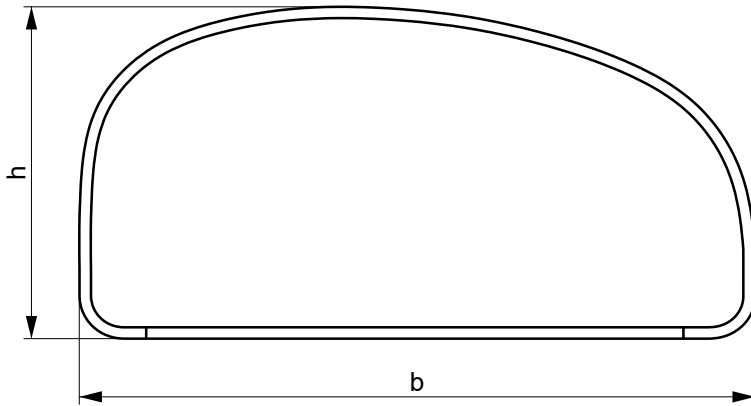

1	producer name
2	normative ref.
3	type A or B
4	batch number
5	model
6	size/R or L
7	metallic toe caps ref.

average hardness of steel releaved
on the top of the toe in the center position : HRc = 48 ± 2

dimension unit:		millimeter										KG	
Tolerance:		±0,05	±0,7	±0,5	±1	±1	±1	-2/ +2	Minimal requirement of		Average performance		± 0,010
Size #	strip lenght - code ref.:	raw material thickness	b	h	l1	l2	l	e	ISO EN 22568:1 A	ISO EN 22568:1 B	200J	15KN	Weight (1 pairs)
4													
5													
6													
7	GAA-4	1,6	83,5	43,0	42,0	46,5	40,4	8,0	20,5	24,5	23,5	32,0	0,180
8	GAA-5	1,6	86,5	43,8	41,8	46,3	40,2	8,0	21,0	25,0	24,0	33,5	0,180
9	GAA-5	1,5	89,0	44,2	43,1	46,8	41,6	8,0	21,5	25,5	24,5	34,0	0,182
10	GAA-6	1,5	89,0	46,0	45,4	50,5	43,9	8,0	22,0	26,0	26,0	35,0	0,186
11	GAA-6	1,5	91,2	46,5	45,0	49,5	43,5	8,0	22,0	26,0	26,5	35,5	0,186
12													

Conformity to the norm Conforme alle norme	<input checked="" type="checkbox"/> ISO EN 22568:1 A	<input type="checkbox"/> ISO EN 22568:1 B	<input checked="" type="checkbox"/> ANSI/ASTM	<input checked="" type="checkbox"/> CSA
---	--	---	---	---