



SAFIT Srl

Via Casonetto,17
36050 Friola (VI)
-- ITALY --
Tel.0444 668335

**Technical Data Sheet
Steel toe cap**

Tabella Dimensionale

Puntali Acciaio

Type

Modello

522

MADE IN ITALY

Written by: Nikola Kostic

Date: 07/01/2023

Rev.02

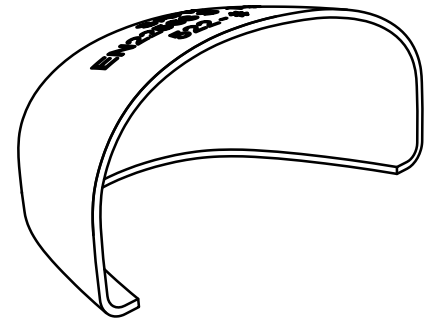
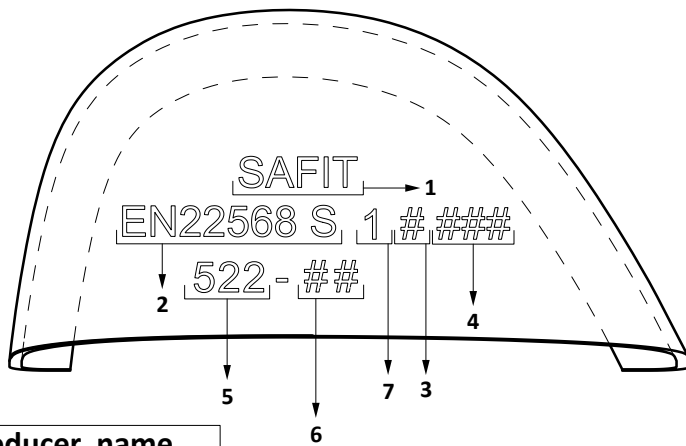
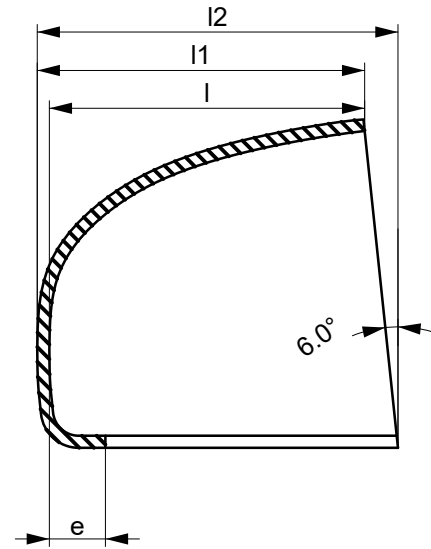
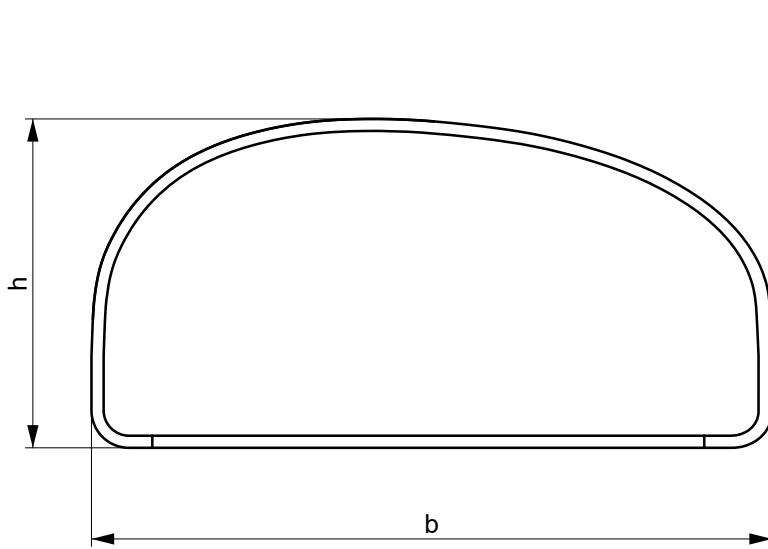

1	producer name
2	normative ref.
3	type A or B
4	batch number
5	model
6	size/R or L
7	metallic toe caps ref.

average hardness of steel releavated
on the top of the toe in the center position :HRc = 48 ± 2

dimension unit:		millimeter											KG	
Tolerance:		±0,05	±0,7	±0,5	±1	±1	±1	-2/ +2	Minimal requirement of		Average performance		± 0,010	
Size #	strip lenght code ref.:	raw material thickness	b	h	l1	l2	l	e	ISO EN 22568:1 A	ISO EN 22568:1 B	200J	15KN	Weight (1 pairs)	
4														
5														
6	GAA-3	1,6	81,5	41,0	44,5	46,0	38,4	8,0	20,0	24,0	21,0	30,0	0,160	
7	GAA-4	1,6	85,5	41,5	41,0	45,5	39,4	8,0	20,5	24,5	21,5	31,5	0,170	
8	GAA-5	1,6	86,5	42,5	46,5	48,5	40,9	8,0	21,0	25,0	21,6	32,0	0,172	
9	GAA-5	1,6	89,4	43,8	47,3	48,3	41,0	8,0	21,5	25,5	22,0	32,5	0,176	
10	GAA-6	1,5	93,0	45,3	50,0	52,0	43,5	8,0	22,0	26,0	22,5	33,0	0,190	
11	GAA-7	1,5	95,6	46,5	50,3	52,0	44,0	8,0	22,0	26,0	24,0	35,0	0,194	
12	GAA-7	1,5	96,4	48,5	50,0	52,3	44,5	8,0	22,0	26,0	23,5	36,0	0,198	
13	GAA-7	1,5	97,0	50,8	48,8	53,5	47,3	8,0	22,0	26,0	27,5	36,0	0,208	
14	GAA-7	1,5	103,5	52,0	50,2	55,3	48,7	8,0	22,0	26,0	28,0	36,0	0,222	
Conformity to the norm Conforme alle norme			<input checked="" type="checkbox"/> ISO EN 22568:1 A				<input type="checkbox"/> ISO EN 22568:1 B			<input checked="" type="checkbox"/> ANSI/ASTM		<input checked="" type="checkbox"/> CSA		