



**SAFIT Srl**

Via Casonetto,17  
36050 Friola (VI)  
-- ITALY --  
Tel.0444 668335

MADE IN ITALY

**Technical Data Sheet  
Steel toe cap**

Tabella Dimensionale

Puntali Acciaio

Type

Modello

**604**

Written by: Nikola Kostic

Date: 07/01/2023

Rev.02

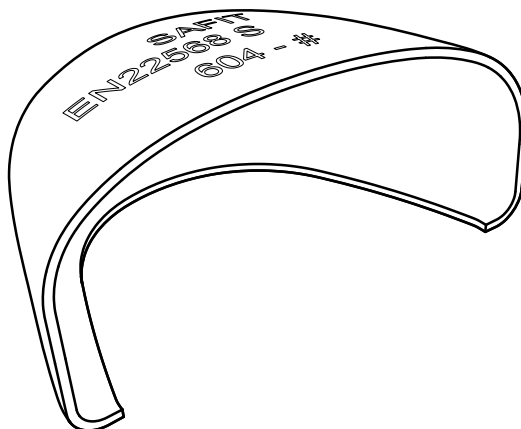
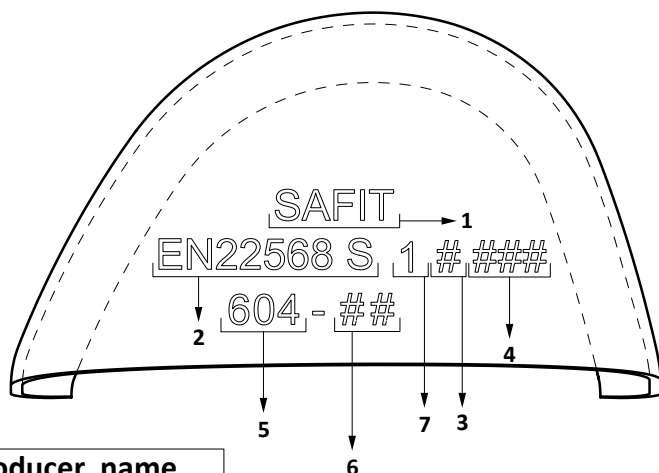
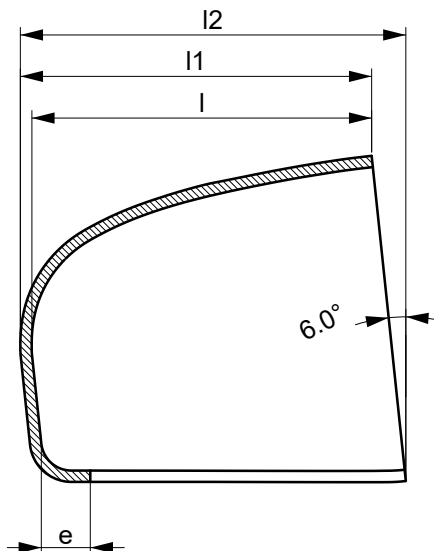
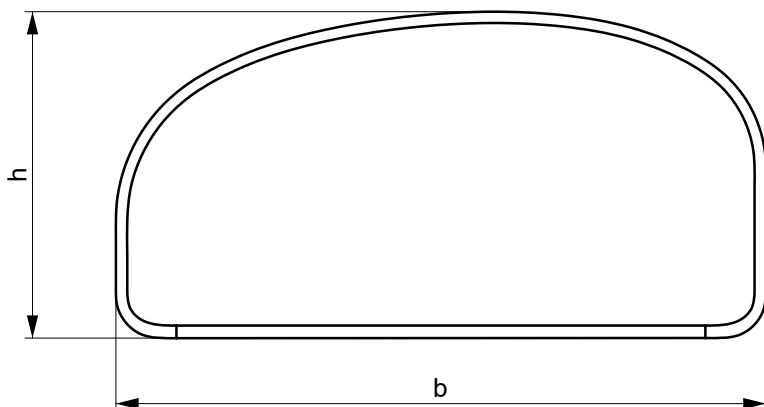

1	producer name
2	normative ref.
3	type A or B
4	batch number
5	model
6	size/ R or L
7	metallic toe caps ref.

average hardness of steel revealed  
on the top of the toe in the center position : HRc = 48 ± 2

dimension unit:			millimeter							KG				
Tolerance:			±0,05	±0,7	±0,5	±1	±1	±1	-2/+2	Minimal requirement of		Average performance		± 0,010
Size #	strip lenght code ref.:	raw material thickness	b	h	l1	l2	l	e	ISO EN 22568:1 A	ISO EN 22568:1 B	200J	15KN	Weight (1 pairs)	
4	GAA-2	1,8	77,9	37,0	42,0	45,0	40,2	8,0	19,5	23,5	24,0	29,0	0,150	
5	GAA-2	1,8	79,5	38,3	41,0	44,5	39,2	8,0	19,5	23,5	21,5	30,0	0,150	
6	GAA-3	1,6	79,6	41,5	40,6	44,0	39,0	8,0	20,0	24,0	25,0	31,0	0,156	
7	GAA-4	1,6	81,5	42,0	42,0	46,5	40,4	8,0	20,5	24,5	23,0	33,0	0,168	
8	GAA-4	1,5	83,5	43,0	43,5	47,5	41,9	8,0	21,0	25,0	23,5	31,5	0,168	
9	GAA-5	1,5	85,6	43,5	44,5	49,0	43,0	8,0	21,5	25,5	24,0	33,0	0,172	
10	GAA-5	1,5	87,0	44,0	45,0	49,5	43,5	8,0	22,0	26,0	25,0	34,5	0,182	
11	GAA-6	1,5	89,5	46,5	48,5	53,0	47,0	8,0	22,0	26,0	25,5	33,5	0,192	
12	GAA-7	1,5	94,5	49,9	47,5	52,5	46,0	8,0	22,0	26,0	28,0	34,0	0,204	

Conformity to the norm Conforme alle norme	<input checked="" type="checkbox"/> ISO EN 22568:1 A	<input type="checkbox"/> ISO EN 22568:1 B	<input checked="" type="checkbox"/> ANSI/ASTM	<input checked="" type="checkbox"/> CSA
---	--	---	---	---