



**SAFIT Srl**

Via Casonetto,17  
36050 Friola (VI)  
-- ITALY --  
Tel.0444 668335

**Technical Data Sheet  
Steel toe cap**

Tabella Dimensionale

Puntali Acciaio

Type

Modello

**700**

MADE IN ITALY

Written by: Nikola Kostic

Date: 07/01/2023

Rev.02

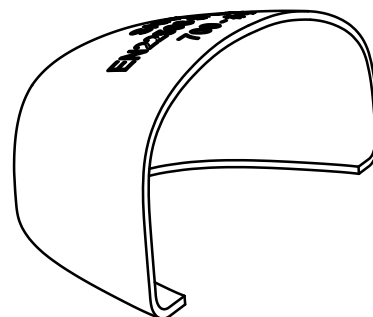
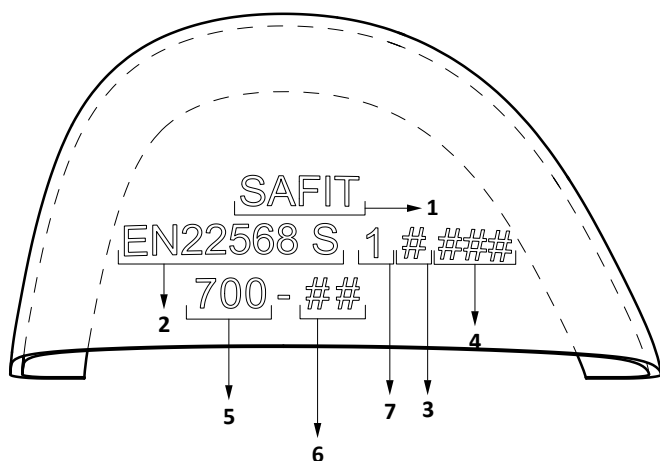
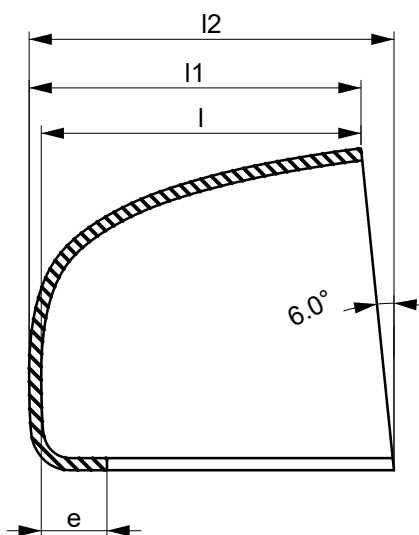
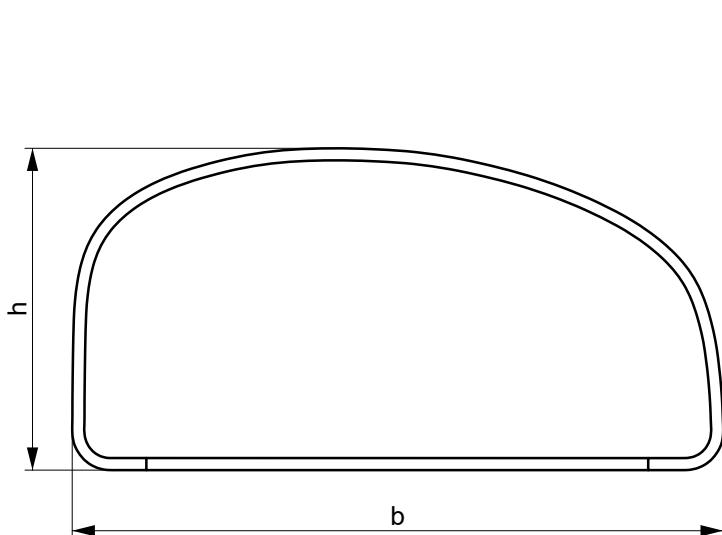

1	producer name
2	normative ref.
3	type A or B
4	batch number
5	model
6	size R or L
7	metallic toe caps ref.

average hardness of steel revealed  
on the top of the toe in the center position : HRc = 48 ± 2

dimension unit:		millimeter										KG	
Tolerance:		±0,05	±0,7	±0,5	±1	±1	±1	-2/ +2	Minimal requirement of		Average performance		± 0,010
Size #	strip lenght code ref.:	raw material thickness	b	h	l1	l2	l	e	ISO EN 22568:1 A	ISO EN 22568:1 B	200J	15KN	Weight (1 pairs)
4													
5		1,8	78,8	36,7	39,4	42,5	37,6	8,0	19,5	23,5	20,0	31,0	0,140
6		1,6	81,0	38,0	41,0	45,0	39,2	8,0	20,0	24,0	20,0	32,0	0,152
7	GAA-4	1,6	84,0	41,1	43,0	47,1	41,4	8,0	20,5	24,5	21,5	33,0	0,188
8	GAA-4	1,6	86,0	42,5	43,8	48,0	42,2	8,0	21,0	25,0	23,0	33,5	0,196
9	GAA-5	1,5	89,5	43,5	45,0	49,5	43,5	8,0	21,5	25,5	25,0	33,5	0,200
10	GAA-5	1,5	91,7	45,0	48,0	52,0	46,5	8,0	22,0	26,0	26,0	34,0	0,210
11	GAA-6	1,5	95,3	45,7	46,9	51,9	45,4	8,0	22,0	26,0	26,5	34,5	0,220
12													

Conformity to the norm Conforme alle norme	<input checked="" type="checkbox"/> ISO EN 22568:1 A	<input type="checkbox"/> ISO EN 22568:1 B	<input checked="" type="checkbox"/> ANSI/ASTM	<input checked="" type="checkbox"/> CSA
---	--	---	---	---